

Licensing Sub-Committee

Agenda

Wednesday 26 April 2023 at 6.30 pm

This meeting will be held remotely

Watch the meeting live: [youtube.com/hammersmithandfulham](https://www.youtube.com/hammersmithandfulham)

MEMBERSHIP

Administration:	Opposition:
Councillor Mercy Umeh (Chair) Councillor Paul Alexander (Vice-Chair)	Councillor Dominic Stanton

CONTACT OFFICER: Charles Francis
Committee Co-ordinator
Governance and Scrutiny
Tel: 07776 672945
E-mail: Charles.Francis@lbhf.gov.uk

Public Notice

This meeting will be held remotely. Members of the press and public can watch the meeting live on YouTube: [youtube.com/hammersmithandfulham](https://www.youtube.com/hammersmithandfulham)

Speaking at Licensing meetings is restricted to those who have submitted a representation and registered to speak.

Date Issued: 17 April 2023

Licensing Sub-Committee Agenda

26 April 2023

<u>Item</u>		<u>Pages</u>
1.	APOLOGIES FOR ABSENCE	
2.	DECLARATIONS OF INTEREST	
	<p>If a Councillor has a disclosable pecuniary interest in a particular item, whether or not it is entered in the Authority's register of interests, or any other significant interest which they consider should be declared in the public interest, they should declare the existence and, unless it is a sensitive interest as defined in the Member Code of Conduct, the nature of the interest at the commencement of the consideration of that item or as soon as it becomes apparent.</p> <p>At meetings where members of the public are allowed to be in attendance and speak, any Councillor with a disclosable pecuniary interest or other significant interest may also make representations, give evidence or answer questions about the matter. The Councillor must then withdraw immediately from the meeting before the matter is discussed and any vote taken.</p> <p>Where Members of the public are not allowed to be in attendance and speak, then the Councillor with a disclosable pecuniary interest should withdraw from the meeting whilst the matter is under consideration. Councillors who have declared other significant interests should also withdraw from the meeting if they consider their continued participation in the matter would not be reasonable in the circumstances and may give rise to a perception of a conflict of interest.</p> <p>Councillors are not obliged to withdraw from the meeting where a dispensation to that effect has been obtained from the Standards Committee.</p>	
3.	SHEPHERDS BUSH FOOD AND WINE, 20 SHEPHERD'S BUSH ROAD, LONDON, W6 7PJ	3 - 51

Agenda Item 3

<u>Contents</u>	<u>Page</u>
1. THE APPLICATION	4
1.1. Current Hours of Operation	4
1.2. Application Requested	4
1.3. Applicants Operating Schedule	5
2. BACKGROUND	5
3. CONSULTATION	5
3.1 Relevant Representations	5
4. OTHER INFORMATION	5
4.1 Enforcement History	5-6
4.2 Temporary Event Notices (“TENS”)	6
5. POLICY CONSIDERATIONS	6-10
6. DETERMINATION	10
<u>APPENDICES</u>	
Copy of current licence and plan.....	11-18
Copy of application form.....	29-29
Copy of correspondence with Police.....	30-34
Map showing location of premises and neighbouring premises.....	35-36
Copy of objections from local residents.....	37-51

1. THE APPLICATION

On 3rd January 2023, Mr Jasmeet Singh Gabha (“the applicant”) submitted an application for a variation to the premises licence to be granted in respect of the premises known as Shepherds Bush Food And Wine, 20 Shepherd's Bush Road, London, W6 7PJ.

1.1 Current Hours of Operation

The premises currently benefit from a premises licence. The current premises licence permits the following:

Sale of Alcohol off the Premises

Monday to Saturday	11:00- 23:00
Sunday	11:00- 22:30

The opening hours of the premises

No restriction

A copy of the current premises licence and plan can be seen on pages **12-19** of this report.

1.2 Application Requested

The applicant has applied to vary their licence to extend the hours for the sale of alcohol, in addition to amending condition 6 on the licence to increase the limit for the strength of alcohol sold as detailed below:

Sale of Alcohol off the Premises

Mondays to Thursdays	08:00 to 00:00
Fridays and Saturdays	08:00 to 01:00
Sundays	08:00 to 23:00

Amend Condition 6 from:

The premises shall not sell nor offer for sale the following products in excess of 5.5% alcohol by volume: beer; lager; stout; ale and cider.

To:

The premises shall not sell nor offer for sale the following products in excess of 9% alcohol by volume: beer; lager; stout; ale and cider.

A copy of the application form can be seen on pages **20-30** of this report.

On the 13th January 2023, following discussion with the Police, the applicant agreed to withdraw the request to amend condition 6 and amended the hours applied for, as detailed below:

Sale of Alcohol off the Premises

Mondays to Sunday - 08:00 to 23:00

Condition 6 to remain: The premises shall not sell nor offer for sale the following products in excess of 5.5% alcohol by volume: beer; lager; stout; ale and cider.

A copy of the relevant correspondence with the police can be seen on pages **31-35** of this report.

1.3 Applicants Operating Schedule

The applicant has proposed steps to promote the four licensing objectives if the application is granted. A copy of these can be seen on pages **27-28** of this report.

2. BACKGROUND

The premises operates as a convenience store. The main access to the premises is located on Shepherds Bush Road at its junction with Sulgrave Road. There is a mixture of both residential and commercial premises within the area (75m buffer zone). A map showing the location of the premises and neighbouring licensed premises can be seen on pages **36-37** of this report.

There are options for transport away from the area including buses and taxis which run from in and around the Shepherds Bush Road area. Goldhawk Road tube station is a 5-minute walk away. Shepherds Bush (Central) tube and Shepherds Bush Overground stations are an 8-minute walk away. Shepherds Bush Market Station is a 9-minute walk away.

3. CONSULTATION

A public notice was displayed at the premises for 28 days. The application was advertised in a local circular and all statutory consultees were notified as required by the Regulations. The Council has served written notice of hearing upon the applicant and all those parties that have made representations in respect of the application.

3.1. Relevant Representations

The licensing section received 20 representations from residents objecting to the licence application. Of these representations, 5 withdrew on the basis of the amendments to application mentioned in section 1.2 of this report. A copy of the 15 representations can be seen on pages **38-52** of this report.

4. OTHER INFORMATION

4.1 Enforcement History

On 16 February 2022 a verbal warning was given following a breach of a licence condition ascertained during a full licensing inspection undertaken at the premises.

On 02 March 2022 an inspection sheet was left at the premises as a warning letter following breaches of licence conditions ascertained during a full licensing inspection undertaken at the premises.

On 13 September 2022 an inspection sheet was left at the premises as a warning letter following breaches of licence conditions ascertained during a full licensing inspection undertaken at the premises.

On 01 December 2022 an inspection sheet was left at the premises as a warning letter following breaches of licence conditions ascertained during a full licensing inspection undertaken at the premises.

4.2 Event Notices (“TENs”)

The premises have had two TENs which have been submitted in respect of this premises in the past twelve months. These are detailed below:

REFVAL	DETAILS	Start Date	End Date
2022/02099/LATEMP	<p>Temporary Event Notice, Shepherds Bush Food and Wine: The premises has an existing licence (2022/00138/LAPR) and the applicant proposes a TEN to extend the hours for the sale of alcohol during the Christmas period.</p> <p>Licensable activities sought: The Sale of Alcohol off the premises only for no more than 2 people.</p> <p>Days and times sought Saturday 24th December 2022 to Tuesday 27 December 2022 between the hours of 08:00 to 01:00 each day.</p>	24/12/2022	27/12/2022
2022/02100/LATEMP	<p>Temporary Event Notice, Shepherds Bush Food and Wine: The premises has an existing licence (2022/00138/LAPR) and the applicant proposes a TEN to extend the hours for the sale of alcohol during the Christmas period.</p> <p>Licensable activities sought: The Sale of Alcohol off the premises only for no more than 2 people.</p> <p>Days and times sought Friday 30th December 2022 to Monday 2nd January 2023 between the hours of 08:00 to 01:00 each day.</p>	30/12/2022	02/01/2023

5. POLICY CONSIDERATIONS

5.1 Section 5 pages 12 and 13 of the Statement of Licensing Policy (“SLP”) states that in order to ensure the promotion of the four Licensing Objectives the Licensing Authority will require applicants to detail in their operating schedule:

- the steps proposed to promote the licensing objective of the prevention of crime and disorder on, and in the vicinity of, the premises, having regard to

their location, character, condition, the nature and extent of the proposed use and the persons likely to use the premises;

- the steps proposed to ensure the physical safety of people using the relevant premises or place;
- how they intend to prevent nuisance arising, prevent disturbance and protect amenity so far as is appropriate to ensure that the Licensing Objectives are met. Where there is a relevant representation regarding extended hours, the Licensing Authority will not permit an extension unless it is satisfied that the Licensing Objectives would be met;
- the measures and management controls in place to protect children from harm. Where appropriate a written childcare policy should be available and be incorporated in the induction of staff.

5.2 Section 7 page 15 of the SLP states that for sales of alcohol for consumption off the premises – applicants in respect of off licences and other premises selling alcohol for consumption off the premises may need to consider whether:

- there are shutters to prevent alcohol from being selected in non-licensed periods.
- there are appropriate numbers of staff on duty to deal with possible ‘intimidation’ to sell alcohol.
- there are restrictions required on the sale of low price, high strength alcohol and drink promotions.
- an incident log book is available to record incidents.
- there are measures in place necessary to prevent underage sales. (See Annex 1)
- there are measures in place necessary to prevent alcohol from being sold outside permitted hours where the operating hours of the premises exceed those for the sale of alcohol.
- there are procedures in place to prevent sales of alcohol to intoxicated persons (with particular attention to street drinkers) or individuals leaving premises in the vicinity such as a late night bar; where there is evidence to suggest this is a problem the Licensing Authority may require a temporary cessation of alcohol sales during high risk times.

5.3 Policy 3 page 21 of the SLP states that where there is a relevant representation, the Licensing Authority will consider each particular case on its merits having regard in particular to the following matters:

- a) Whether the licensed activities are likely to have an adverse impact especially on local residents and, if there is potential to have an adverse impact, what, if any, appropriate measures will be put in place to prevent it;
- b) Whether there will be a substantial increase in the cumulative adverse impact from these or similar activities, on an adjacent residential area;
- c) Whether there is a suitable level of public transport accessibility to and from the premises at the appropriate times;
- d) Whether the activity will be likely to lead to a harmful and unmanageable increase in car parking demand in surrounding residential streets suffering high levels of parking stress or on roads forming part of the Strategic London Road Network or the London Bus Priority Network leading to a negative impact on the Licensing Objectives relating to the prevention of crime, disorder, anti-social behaviour (ASB), nuisance and vehicle emissions;

e) Whether there have been any representations made by Responsible Authorities, or other relevant agency or representative.

The Licensing Authority will closely scrutinise extended hours applications to ensure that the Licensing Objectives are met. In determining an application the licensing committee might decide that the circumstances are such that a restriction on hours is the only appropriate means to achieve the Licensing Objectives. If an 'hours' restriction is imposed, the Licensing Authority will normally require that customers should be allowed a minimum of thirty minutes to consume alcohol.

To act as a guide for new or existing operators we have set out the suggested closing times for licensed premises below:

Type of premises	Town centres	Mixed use areas	Residential areas
Off-licences and alcohol sales in Supermarkets	23:00 daily	23:00 daily	22:00 daily

5.4 Policy 11 page 30 of the SLP states that population densities in this borough are high, with many residential premises located above or in close proximity to licensed premises. This means that the public nuisance and crime and disorder objectives will be of paramount concern when evaluating Operating Schedules. Licensing Committees will place high regard on the control measures put in place by the applicant to ensure that our residents are protected from the potential detrimental effects of any licensed premises.

5.5 Annex 1 pages 35 and 36 of the SLP in relation to the prevention of crime and disorder states licence applicants will be expected to demonstrate the following in their operating schedules:

c) Operators of off-licences in areas problems relating to street drinking and under age drinking are prevalent, measures should be outlined to strictly monitor the way alcohol is sold, specifically where the premises are located close to schools and hostels and similar premises that provide shelter or services to alcohol dependent persons.

d) It is important to ensure that staff working at off licences are suitably trained and receive appropriate refresher training in their responsibilities under the Act and can discharge their duties in full compliance with the licence conditions and requirements of the Act. This includes the ability to competently check a customer's age with acceptable forms of identification where necessary. The Licensing Authority will particularly consider the following matters where they are material to the individual application:

- i. The likelihood of any violence, public order or policing problem if the licence is granted;
- ii. The measures taken to control admission to the premises, and to take reasonable steps to prevent the occurrence of crime and disorder and public nuisance immediately outside the premises, where and to the extent that these matters are within their control.

- iii. Past conduct and prior history of complaints against the premises;
 - iv. Whether a dispersal policy has been prepared to minimise the potential for disorder as customers leave the premises; and
 - v. Any relevant representations.
- g) Conditions will, so far as possible, reflect local crime prevention strategies, and the Licensing Authority will also have regard to the views of the local Crime and Disorder Reduction Partnership.
- h) Crime and disorder in the vicinity of the premises: this may include the crime and disorder risks arising from persons queuing to enter the premises; persons exiting the premises and customers smoking eating or drinking in outdoor areas and on the highway outside the premises. This can also include crime arising from pickpockets and bag snatchers, particularly in open spaces or crowded areas where alcohol is being consumed.
- j) CCTV - using CCTV inside and/or outside the premises together with appropriate procedures and having staff properly trained to use CCTV equipment.
- k) dispersal procedures - establishing appropriate dispersal procedures to minimise the potential for crime and disorder when customers are leaving the premises.

5.6 Annex 1 pages 38 to 40 of the SLP in relation to the prevention of public nuisance states that the Licensing Authority will particularly consider the following matters where they are material to the individual application:

- ii. The proximity of residential accommodation;
- iii. The type of use proposed, including the likely numbers of customers, proposed hours of operation and the frequency of activity;
- v. The steps taken or proposed to be taken by the applicant to prevent disturbance by customers arriving at or leaving the premises.
- viii. The steps taken or proposed to be taken by the applicant to prevent queuing (either by pedestrian or vehicular traffic). If some queuing is inevitable then queues should be diverted away from neighbouring premises or be otherwise managed to prevent disturbance or obstruction;
- ix. The steps taken or proposed to be taken by the applicant to ensure staff leave the premises quietly;
- x. The arrangements made or proposed for parking by patrons, and the effect of parking by patrons on local residents;
- xi. The provision for public transport in the locality (including taxis and private hire vehicles) for patrons;
- xii. The level of likely disturbance from associated vehicular and pedestrian movement to and from the premises;
- xiii. The delivery and collection areas and delivery/collection times;
- xv. The arrangements for refuse disposal, storage and the prevention/tidying of litter (including fly posters and illegal placards);
- xix. Any other relevant activity likely to give rise to nuisance;
- xx. Any representations made by the Police, or other relevant agency or representative;

The following provides a non-exhaustive list of risks associated with the public nuisance objective that applicants may want to consider when preparing their Operating Schedule:

- j) **Deliveries/collections** – noise from deliveries to and/or collections (e.g. refuse) from the premises are another common source of complaint. Consider the times of

such deliveries/collections and make sure you specify to any contractors that deliveries/collections should not be made at anti-social times. As a guide, the Noise and Nuisance Service recommend that deliveries/collections should only be made between the hours of 7:30am and 9:00pm, depending on the proximity of residential and/or other noise sensitive properties.

k) **Late night refreshment** - applicants in respect of late night takeaways should demonstrate that they have assessed the risk of persons congregating in large numbers in the vicinity of their premises. Where appropriate, applicants should demonstrate suitable measures to address this problem.

l) **Light pollution** – this is an increasingly common source of complaint, particularly from illuminated signs and external security lighting. Where provided, illuminated signs should not cause glare to neighbouring properties, ideally being turned off at night, and external lighting should be angled and/or diffused to also prevent nuisance.

p) **Queue management** - establishing appropriate procedures to avoid the need for customers to queue before entering the premises or, where queuing cannot be avoided, to manage queues so as to minimise the potential for crime and disorder or public nuisance by customers who are queuing.

r) **Waste** – consider how and where waste will be stored/disposed of at the end of trading hours, particularly if trading until late at night. This is important because the disposal of glass and/or cans to outside bin areas can be very noisy and give rise to complaints, so it may be necessary to store such items and other non-degradable refuse inside the premises until the next trading day. Consideration should also be given to the time of deliveries to minimize disruption to local residents.

s) **Litter** – for example, litter patrols for late night take-away premises

6. DETERMINATION

6.1 In determining this application, the Committee must have regard to the representations and take such of the following steps as it considers necessary for the promotion of the licensing objectives. The steps are:

(a) Grant the application in full

(b) Grant the application in part – modifying the proposed hours, activities or conditions.

(c) Reject the application

It is the Council's duty under the Licensing Act 2003 ("The Act") to determine applications with a view to promoting the four licensing objectives; Prevention of Crime and Disorder, Public Safety, Prevention of Public Nuisance and the Protection of Children from Harm.

In reaching a decision the Council shall consider the details of any relevant representations received; the applicant's Operating Schedule; the Council's adopted Statement of Licensing Policy and the guidance issued by the Secretary of State under section 182 of the Act.

If the Committee is minded to grant the application conditions may be attached to the licence to alleviate the concerns raised through the representations.

Licensing Act 2003

Premises Licence



Premises Licence Number: 2022/00138/LAPR

Part 1 – Premises details

Postal address of premises, or if none, OS map reference or description of the premises

Shepherds Bush Food And Wine
20 Shepherd's Bush Road

Post town: London

Post code: W6 7PJ

Telephone:

Where the licence is time limited the dates:

Not Applicable

Licensable activities authorised by the licence:

Sale of Alcohol Off the Premises

The licence authorises the carrying out of the following licensable activities on the days and at the times specified below:

Sale of Alcohol Off the Premises

Monday	11:00 - 23:00
Tuesday	11:00 - 23:00
Wednesday	11:00 - 23:00
Thursday	11:00 - 23:00
Friday	11:00 - 23:00
Saturday	11:00 - 23:00
Sunday	11:00 - 22:30

The opening hours of the premises:

No Restrictions

Where the licence authorises supplies of alcohol whether these are on and / or off supplies:

Off the premises only

Part 2

Name, (registered) address, telephone number and email (where relevant) of holder of premises licence:

Mr Jasmeet Singh Gabha
● Craneswater Park
Southall
UB2 5RW

Email ●●●●●●●●●●●●●●●●

Registered number of holder, for example company number, charity number (where applicable):

Not Applicable

Name, address and telephone number of designated premises supervisor where the premises licence authorises the supply of alcohol:

Mr Jasmeet Singh Gabha
● Craneswater Park
Southall
UB2 5RW

Licensing Authority: London Borough Of Ealing
Personal Licence Number: 21LIC17251PERS.

Annex 1 – Mandatory Conditions

1. Mandatory Condition

1) The premises licence holder or club premises certificate holder must ensure that an age verification policy is adopted in respect of the premises in relation to the sale or supply of alcohol.

(2) The designated premises supervisor in relation to the premises licence must ensure that the supply of alcohol at the premises is carried on in accordance with the age verification policy.

(3) The policy must require individuals who appear to the responsible person to be under 18 years of age (or such older age as may be specified in the policy) to produce on request, before being served alcohol, identification bearing their photograph, date of birth and either—

- (a) a holographic mark, or
- (b) an ultraviolet feature.

2. Mandatory Condition

1.A relevant person shall ensure that no alcohol is sold or supplied for consumption on or off the premises for a price which is less than the permitted price.

2. For the purposes of the condition set out in paragraph 1—

(a) "duty" is to be construed in accordance with the Alcoholic Liquor Duties Act 1979;

(b) "permitted price" is the price found by applying the formula—

$$P = D + (D \times V)$$

where—

(i) P is the permitted price,

(ii) D is the amount of duty chargeable in relation to the alcohol as if the duty were charged on the date of the sale or supply of the alcohol, and

(iii) V is the rate of value added tax chargeable in relation to the alcohol as if the value added tax were charged on the date of the sale or supply of the alcohol;

(c) "relevant person" means, in relation to premises in respect of which there is in force a premises licence—

(i) the holder of the premises licence,

(ii) the designated premises supervisor (if any) in respect of such a licence, or

(iii) the personal licence holder who makes or authorises a supply of alcohol under such a licence;

(d) "relevant person" means, in relation to premises in respect of which there is in force a club premises certificate, any member or officer of the club present on the premises in a capacity which enables the member or officer to prevent the supply in question; and

(e) "value added tax" means value added tax charged in accordance with the Value Added Tax Act 1994.

3. Where the permitted price given by Paragraph (b) of paragraph 2 would (apart from this paragraph) not be a whole number of pennies, the price given by that sub-paragraph shall be taken to be the price actually given by that sub-paragraph rounded up to the nearest penny.

4(1) Sub-paragraph (2) applies where the permitted price given by Paragraph (b) of paragraph 2 on a day ("the first day") would be different from the permitted price on the next day ("the second day") as a result of a change to the rate of duty or value added tax.

(2) The permitted price which would apply on the first day applies to sales or supplies of alcohol which take place before the expiry of the period of 14 days beginning on the second day.

3. Mandatory Condition

(1) No supply of alcohol may be made under the premises licence-

(a) at a time when there is no designated premises supervisor in respect of the premises licence, or

(b) at a time when the designated premises supervisor does not hold a personal licence or his personal licence is suspended.

(2) Every supply of alcohol under the premises licence must be made or authorised by a person who holds a personal licence.

Annex 2 – Conditions consistent with the operating Schedule

4. Alcohol shall not be sold or supplied in an open container or be consumed in the licensed premises.

5. Alcohol shall not be sold or supplied unless it is paid for before or at the time when it is sold or supplied.

Annex 3 – Conditions attached after a hearing by the licensing authority

6. The premises shall not sell nor offer for sale the following products in excess of 5.5% alcohol by volume: beer; lager; stout; ale and cider.

7. All staff involved in the sale of alcohol at the premises shall be required to take and pass a nation accredited licensing qualification.

8. The premises licence holder shall operate a refusals book which shall be paginated and made available for inspections by authorised authorities.

9. The premise shall use a till operation system which provide an ID confirmation prompt when alcohol is scanned.

10. The premises shall operate a Challenge 25 policy. Only photographic ID such as British Driving Licence, a Current Passport or a PASS ID card shall be treated as acceptable forms of identification.

11. All staff shall be trained in the Proof of Age policy and how to identify acceptable means of identification.

12. Appropriate signage shall be displayed in a prominent position, informing customer they are being recorded on CCTV.

13. CCTV covering areas inside and outside of the premises should be installed and maintained to Police recommendations with properly maintained log arrangements. All images shall be stored for a minimum of 31 days.

14. A staff member forms the premises that is conversant with the operations of the CCTV system shall always be on the premises at all times that the premises are open to the public. This staff member shall be able to show Police or authorised local authority officers recent data footage with the minimum of delay when requested. This data or footage reproduction should be almost instantaneous

Signed: 
Authorised Officer

Date: 18.02.2022

Annex 4- Plans:

Please insert plans at page 5

Licensing Act 2003

Premises Licence



Premises Licence Summary

Premises Licence Number: 2022/00138/LAPR

Premises details

Postal address of premises, or if none, OS map reference or description of the premises

Shepherds Bush Food And Wine
20 Shepherd's Bush Road

Post town: London

Post code: W6 7PJ

Telephone:

Where the licence is time limited the dates:

Not Applicable

Licensable activities authorised by the licence:

Sale of Alcohol Off the Premises

The licence authorises the carrying out of the following licensable activities on the days and at the times specified below:

Sale of Alcohol Off the Premises

Monday	11:00 - 23:00
Tuesday	11:00 - 23:00
Wednesday	11:00 - 23:00
Thursday	11:00 - 23:00
Friday	11:00 - 23:00
Saturday	11:00 - 23:00
Sunday	11:00 - 22:30

The opening hours of the premises:

No restriction 00:00 - 00:00

Where the licence authorises supplies of alcohol whether these are on and / or off supplies:

Off the premises only

Name, (registered) address, of holder of premises licence:

Mr Jasmeet Singh Gabha
● Craneswater Park
Southall
UB2 5RW

Registered number of holder, for example company number, charity number (where applicable):

Not Applicable

Name of designated premises supervisor where the premises licence authorises the supply of alcohol:

Mr Jasmeet Singh Gabha

State whether access to the premises by children is restricted or prohibited:

No Restrictions

Signed: 
Authorised Officer

Date: 18.02.2022

Licence number:
2005/04144/LAPRT

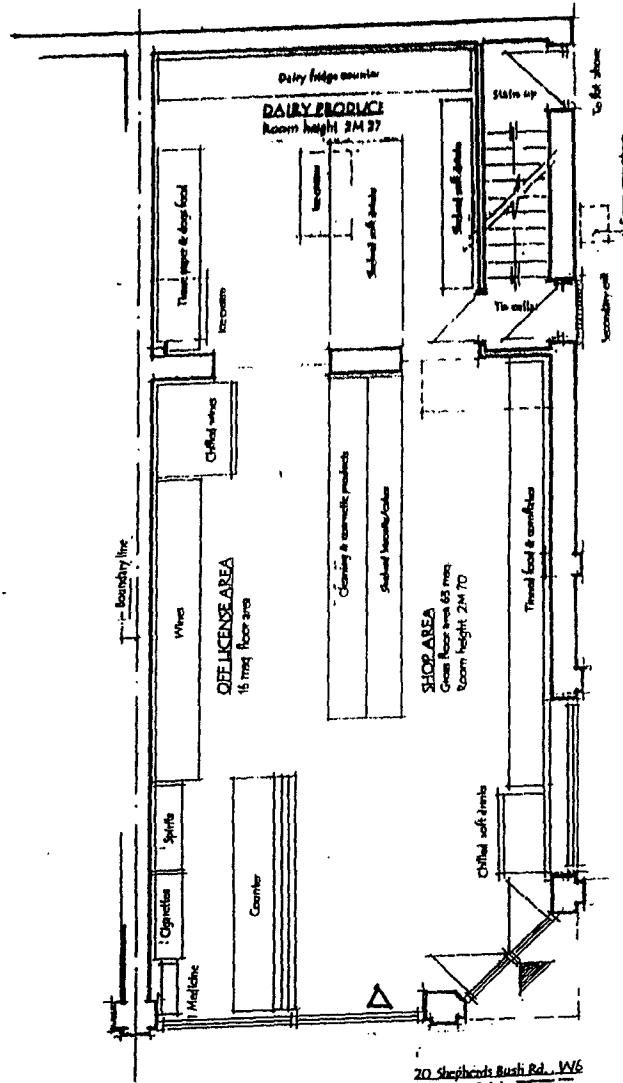

△ Fire Ex

GROUND FLOOR PLAN OF 'FAIRWAYS FOODS LTD'. Re: LICENSING ACT 2003 - APPLICATION
20 Shepherds Bush Road, London W6 7PJ
Proprietor: Mr Raja Amjad Ishaq
Scale: 1:100
Joe Broggin Building Surveyor 45 Margravine Gdns., London W6 8RN
Tel: 020 7603 8041
Date: 31/07/2005



Hammersmith and Fulham
Application to vary a premises licence
Licensing Act 2003

For help contact
licensing@lbhf.gov.uk
 Telephone: 020 8753 1081

* required information

Section 1 of 18

You can save the form at any time and resume it later. You do not need to be logged in when you resume.

System reference This is the unique reference for this application generated by the system.

Your reference You can put what you want here to help you track applications if you make lots of them. It is passed to the authority.

Are you an agent acting on behalf of the applicant? Put "no" if you are applying on your own behalf or on behalf of a business you own or work for.

Yes No

Applicant Details

* First name

* Family name

* E-mail

Main telephone number Include country code.

Other telephone number

Indicate here if you would prefer not to be contacted by telephone

Are you:

Applying as a business or organisation, including as a sole trader

Applying as an individual

A sole trader is a business owned by one person without any special legal structure. Applying as an individual means you are applying so you can be employed, or for some other personal reason, such as following a hobby.

Applicant Business

Is your business registered in the UK with Companies House? Yes No

Registration number

Business name If your business is registered, use its registered name.

VAT number Put "none" if you are not registered for VAT.

Legal status

Note: completing the Applicant Business section is optional in this form.

Continued from previous page...

Your position in the business

Home country

The country where the headquarters of your business is located.

Registered Address

Address registered with Companies House.

Building number or name

Street

District

City or town

County or administrative area

Postcode

Country

Section 2 of 18

APPLICATION DETAILS

This application cannot be used to vary the licence so as to extend the period for which the licence has effect or to vary substantially the premises to which it relates. If you wish to make that type of change to the premises licence, you should make a new premises licence application under section 17 of the Licensing Act 2003.

I/we, as named in section 1, being the premises licence holder, apply to vary a premises licence under section 34 of the Licensing Act 2003 for the premises described in section 2 below.

* Premises Licence Number

Are you able to provide a postal address, OS map reference or description of the premises?

- Address OS map reference Description

Postal Address Of Premises

Building number or name

Street

District

City or town

County or administrative area

Postcode

Country

Premises Contact Details

Telephone number

Continued from previous page...

Non-domestic rateable value of premises (£)

8,483

Section 3 of 18

VARIATION

Do you want the proposed variation to have effect as soon as possible?

Yes No

Do you want the proposed variation to have effect in relation to the introduction of the late night levy?

Yes No

You do not have to pay a fee if the only purpose of the variation for which you are applying is to avoid becoming liable to the late night levy.

If your proposed variation would mean that 5,000 or more people are expected to attend the premises at any one time, state the number expected to attend

Describe Briefly The Nature Of The Proposed Variation

Describe the premises. For example the type of premises, its general situation and layout and any other information which could be relevant to the licensing objectives. Where your application includes off-supplies of alcohol and you intend to provide a place for consumption of these off-supplies, you must include a description of where the place will be and its proximity to the premises.

Dear Sir/Madam, our current premises license starts at 11.00am we have a lot of customers that ask us for alcohol before that but we cannot supply due to our timing restrictions in the license. It would be heavily appreciated if you can change our licensing timing from 8.00am. In addition to that our license finishes at 23.00pm Mon-Sat and at 22.30 on Sundays we would also like to change the timing for that to midnight from Mon-Thurs and Fridays and Saturdays till 1.00am and 23.00 on Sundays. Besides that we are not permitted to sell beers more than 5.5%, we would also appreciate if you can give us a strong beer license or even till 9%. I can understand I am probably asking for too much but as you know we are a new business it is hard to survive with all the costs going up with utilities etc we do require more profit in order for us to keep going and keeping up to our expenses. In addition the area we are located in has a very high foot fall as we have the high street near to us and so many hotels which tourists reside in, we can not provide the required customer service to them due to all the restrictions we have on our premises license.

Section 4 of 18

PROVISION OF PLAYS

[See guidance on regulated entertainment](#)

Will the schedule to provide plays be subject to change if this application to vary is successful?

Yes No

Section 5 of 18

PROVISION OF FILMS

[See guidance on regulated entertainment](#)

Continued from previous page...

Will the schedule to provide films be subject to change if this application to vary is successful?

- Yes No

Section 6 of 18

PROVISION OF INDOOR SPORTING EVENTS

[See guidance on regulated entertainment](#)

Will the schedule to provide indoor sporting events be subject to change if this application to vary is successful?

- Yes No

Section 7 of 18

PROVISION OF BOXING OR WRESTLING ENTERTAINMENTS

[See guidance on regulated entertainment](#)

Will the schedule to provide boxing or wrestling entertainments be subject to change if this application to vary is successful?

- Yes No

Section 8 of 18

PROVISION OF LIVE MUSIC

[See guidance on regulated entertainment](#)

Will the schedule to provide live music be subject to change if this application to vary is successful?

- Yes No

Section 9 of 18

PROVISION OF RECORDED MUSIC

[See guidance on regulated entertainment](#)

Will the schedule to provide recorded music be subject to change if this application to vary is successful?

- Yes No

Section 10 of 18

PROVISION OF PERFORMANCES OF DANCE

[See guidance on regulated entertainment](#)

Will the schedule to provide performances of dance be subject to change if this application to vary is successful?

- Yes No

Section 11 of 18

PROVISION OF ANYTHING OF A SIMILAR DESCRIPTION TO LIVE MUSIC, RECORDED MUSIC OR PERFORMANCES OF DANCE

[See guidance on regulated entertainment](#)

Continued from previous page...

Will the schedule to provide anything similar to live music, recorded music or performances of dance be subject to change if this application to vary is successful?

Yes No

Section 12 of 18

PROVISION OF LATE NIGHT REFRESHMENT

Will the schedule to provide late night refreshment be subject to change if this application to vary is successful?

Yes No

Section 13 of 18

SUPPLY OF ALCOHOL

Will the schedule to supply alcohol be subject to change if this application to vary is successful?

Yes No

Standard Days And Timings

MONDAY

Start

End

Start

End

Provide timings in 24 hour clock (e.g., 16:00) and only give details for the days of the week when you intend the premises to be used for the activity.

TUESDAY

Start

End

Start

End

WEDNESDAY

Start

End

Start

End

THURSDAY

Start

End

Start

End

FRIDAY

Start

End

Start

End

SATURDAY

Start

End

Start

End

Continued from previous page...

SUNDAY

Start

End

Start

End

Will the sale of alcohol be for consumption?

- On the premises Off the premises Both

If the sale of alcohol is for consumption on the premises select on, if the sale of alcohol is for consumption away from the premises select off. If the sale of alcohol is for consumption on the premises and away from the premises select both.

State any seasonal variations.

For example (but not exclusively) where the activity will occur on additional days during the summer months.

Non-standard timings. Where the premises will be used for the supply of alcohol at different times from those listed above, list below.

For example (but not exclusively), where you wish the activity to go on longer on a particular day e.g. Christmas Eve.

Christmas Eve & New Years Eve till 1.00-2.00am

Section 14 of 18

ADULT ENTERTAINMENT

Highlight any adult entertainment or services, activities, or other entertainment or matters ancillary to the use of the premises that may give rise to concern in respect of children.

Provide information about anything intended to occur at the premises or ancillary to the use of the premises which may give rise to concern in respect of children, regardless of whether you intend children to have access to the premises, for example (but not exclusively) nudity or semi-nudity, films for restricted age groups etc gambling machines etc.

Section 15 of 18

HOURS PREMISES ARE OPEN TO THE PUBLIC

Standard Days And Timings

MONDAY

Start

End

Start

End

Provide timings in 24 hour clock (e.g., 16:00) and only give details for the days of the week when you intend the premises to be used for the activity.

Continued from previous page...

TUESDAY

Start	<input type="text" value="00:00"/>	End	<input type="text" value="23:00"/>
Start	<input type="text"/>	End	<input type="text"/>

WEDNESDAY

Start	<input type="text" value="00:00"/>	End	<input type="text" value="23:00"/>
Start	<input type="text"/>	End	<input type="text"/>

THURSDAY

Start	<input type="text" value="00:00"/>	End	<input type="text" value="23:00"/>
Start	<input type="text"/>	End	<input type="text"/>

FRIDAY

Start	<input type="text" value="00:00"/>	End	<input type="text" value="23:00"/>
Start	<input type="text"/>	End	<input type="text"/>

SATURDAY

Start	<input type="text" value="00:00"/>	End	<input type="text" value="23:00"/>
Start	<input type="text"/>	End	<input type="text"/>

SUNDAY

Start	<input type="text" value="00:00"/>	End	<input type="text" value="22:30"/>
Start	<input type="text"/>	End	<input type="text"/>

State any seasonal variations.

For example (but not exclusively) where the activity will occur on additional days during the summer months.

These are our premises timings for the shop, but our alcohol supply timings is not the same we do not have permission till 11.00am

Non standard timings. Where you intend to use the premises to be open to the members and guests at different times from those listed above, list below.

For example (but not exclusively), where you wish the activity to go on longer on a particular day e.g. Christmas Eve.

Continued from previous page...

Identify those conditions currently imposed on the licence which you believe could be removed as a consequence of the proposed variation you are seeking.

Condition 6

The premises shall not sell nor offer for sale the following products in excess of 5.5% alcohol by volume: beer, lager, stout, ale and cider

- I have enclosed the premises licence
- I have enclosed the relevant part of the premises licence

Reasons why I have failed to enclose the premises licence or relevant part of premises licence.

Section 16 of 18

LICENSING OBJECTIVES

Describe the steps you intend to take to promote the four licensing objectives:

a) General – all four licensing objectives (b,c,d,e)

List here steps you will take to promote all four licensing objectives together.

I will train staff to contribute to well-run the premises and have a responsible approach to the sale of alcohol. All staff will be advised of licensing law in writing before they are allowed to serve alcohol.

b) The prevention of crime and disorder

An alarm and other security measure are installed at the premises to protect it when closed or empty with CCTV footage up to 31 days. A panic alarm connected to verisure is also installed in the matter of crime.

c) Public safety

A risk assessment is carried out each 12 months to identify potential hazards posed to staff or customers and setting out precautions to manage the hazards. All staff will also be made aware of the risk assessment and precautionary measures.

d) The prevention of public nuisance

We will reduce the potential for excessive queue lines with a well managed and efficient door policy. Queues should be actively managed by door staff, especially later in the evening, to keep noise to a minimum. Rowdy behavior from people queuing to get will not be tolerated. Door staff will refuse entry to anyone behaving in an anti-social way.

e) The protection of children from harm

A documented policy is set out measures to protect children from harm is in place at the premises. We operate a strict 'No ID – No Sale' policy. No alcohol 'Challenge 21' scheme serves as a reminder to staff of

Continued from previous page...

the need to be vigilant in preventing underage sales and to customers that it is against the law for anyone under 18 to purchase alcohol. A 'Challenge 25' scheme gives staff additional support and encouragement to ask for ID from any person appearing to be under 25 years of age to prove that they are over 18. We also Keep a refusals book and ensure it is completed whenever a sale is refused to a person who cannot prove they are over the age of 18.

Section 17 of 18

NOTES ON REGULATED ENTERTAINMENT

In terms of specific **regulated entertainments** please note that:

- Plays: no licence is required for performances between 08:00 and 23.00 on any day, provided that the audience does not exceed 500.
- Films: no licence is required for 'not-for-profit' film exhibition held in community premises between 08.00 and 23.00 on any day provided that the audience does not exceed 500 and the organiser (a) gets consent to the screening from a person who is responsible for the premises; and (b) ensures that each such screening abides by age classification ratings.
- Indoor sporting events: no licence is required for performances between 08.00 and 23.00 on any day, provided that the audience does not exceed 1000.
- Boxing or Wrestling Entertainment: no licence is required for a contest, exhibition or display of Greco-Roman wrestling, or freestyle wrestling between 08.00 and 23.00 on any day, provided that the audience does not exceed 1000. Combined fighting sports – defined as a contest, exhibition or display which combines boxing or wrestling with one or more martial arts – are licensable as a boxing or wrestling entertainment rather than an indoor sporting event.
- Live music: no licence permission is required for:
 - o a performance of unamplified live music between 08.00 and 23.00 on any day, on any premises.
 - o a performance of amplified live music between 08.00 and 23.00 on any day on premises authorised to sell alcohol for consumption on those premises, provided that the audience does not exceed 500.
 - o a performance of amplified live music between 08.00 and 23.00 on any day, in a workplace that is not licensed to sell alcohol on those premises, provided that the audience does not exceed 500.
 - o a performance of amplified live music between 08.00 and 23.00 on any day, in a church hall, village hall, community hall, or other similar community premises, that is not licensed by a premises licence to sell alcohol, provided that (a) the audience does not exceed 500, and (b) the organiser gets consent for the performance from a person who is responsible for the premises.
 - o a performance of amplified live music between 08.00 and 23.00 on any day, at the non-residential premises of (i) a local authority, or (ii) a school, or (iii) a hospital, provided that (a) the audience does not exceed 500, and (b) the organiser gets consent for the performance on the relevant premises from: (i) the local authority concerned, or (ii) the school or (iii) the health care provider for the hospital.
- Recorded Music: no licence permission is required for:
 - o any playing of recorded music between 08.00 and 23.00 on any day on premises authorised to sell alcohol for consumption on those premises, provided that the audience does not exceed 500.
 - o any playing of recorded music between 08.00 and 23.00 on any day, in a church hall, village hall, community hall, or other similar community premises, that is not licensed by a premises licence to sell alcohol, provided that (a) the audience does not exceed 500, and (b) the organiser gets consent for the performance from a person who is responsible for the premises.
 - o any playing of recorded music between 08.00 and 23.00 on any day, at the non-residential premises of (i) a local authority, or (ii) a school, or (iii) a hospital, provided that (a) the audience does not exceed 500, and (b) the organiser gets consent for the performance on the relevant premises from: (i) the local authority concerned, or (ii) the school proprietor or (iii) the health care provider for the hospital.

Continued from previous page...

- Dance: no licence is required for performances between 08.00 and 23.00 on any day, provided that the audience does not exceed 500. However, a performance which amounts to adult entertainment remains licensable.
- Cross activity exemptions: no licence is required between 08.00 and 23.00 on any day, with no limit on audience size for:
 - o any entertainment taking place on the premises of the local authority where the entertainment is provided by or on behalf of the local authority;
 - o any entertainment taking place on the hospital premises of the health care provider where the entertainment is provided by or on behalf of the health care provider;
 - o any entertainment taking place on the premises of the school where the entertainment is provided by or on behalf of the school proprietor; and
 - o any entertainment (excluding films and a boxing or wrestling entertainment) taking place at a travelling circus, provided that (a) it takes place within a moveable structure that accommodates the audience, and (b) that the travelling circus has not been located on the same site for more than 28 consecutive days.

Section 18 of 18

PAYMENT DETAILS

This fee must be paid to the authority. If you complete the application online, you must pay it by debit or credit card.

Variation Fees are determined by the non-domestic rateable value of the premises.

To find out a premises non domestic rateable value go to the Valuation Office Agency site at http://www.voa.gov.uk/business_rates/index.htm

Band A - No RV to £4300 £100.00

Band B - £4301 to £33000 £190.00

Band C - £33001 to £8700 £315.00

Band D - £87001 to £12500 £450.00*

Band E - £125001 and over £635.00*

*If the premises rateable value is in Bands D or E and the premises is primarily used for the consumption of alcohol on the premises then your are required to pay a higher fee

Band D - £87001 to £12500 £900.00

Band E - £125001 and over £1,905.00

If you own a large premise you are subject to additional fees based upon the number in attendance at any one time

Capacity 5000-9999 £1,000.00

Capacity 10000 -14999 £2,000.00

Capacity 15000-19999 £4,000.00

Capacity 20000-29999 £8,000.00

Capacity 30000-39000 £16,000.00

Capacity 40000-49999 £24,000.00

Capacity 50000-59999 £32,000.00

Capacity 60000-69999 £40,000.00

Capacity 70000-79999 £48,000.00

Capacity 80000-89999 £56,000.00

Capacity 90000 and over £64,000.00

* Fee amount (£)

190.00

DECLARATION

* It is an offence, under section 158 of the licensing act 2003, to make a false statement in or in connection with this application. Those who make a false statement may be liable on summary conviction to a fine of any amount.

Ticking this box indicates you have read and understood the above declaration

This section should be completed by the applicant, unless you answered "Yes" to the question "Are you an agent acting on behalf of the applicant?"

Continued from previous page...

* Full name

* Capacity

* Date / /
dd mm yyyy

Once you're finished you need to do the following:

1. Save this form to your computer by clicking file/save as...
 2. Go back to <https://www.gov.uk/apply-for-a-licence/premises-licence/hammersmith-and-fulham/change-1> to upload this file and continue with your application.
- Don't forget to make sure you have all your supporting documentation to hand.

IT IS AN OFFENCE, UNDER SECTION 158 OF THE LICENSING ACT 2003, TO MAKE A FALSE STATEMENT IN OR IN CONNECTION WITH THIS APPLICATION. THOSE WHO MAKE A FALSE STATEMENT MAY BE LIABLE ON SUMMARY CONVICTION TO A FINE OF ANY AMOUNT.

OFFICE USE ONLY

Applicant reference number

Fee paid

Payment provider reference

ELMS Payment Reference

Payment status

Payment authorisation code

Payment authorisation date

Date and time submitted

Approval deadline

Error message

Is Digitally signed

[1](#) [2](#) [3](#) [4](#) [5](#) [6](#) [7](#) [8](#) [9](#) [10](#) [11](#) [12](#) [13](#) [14](#) [15](#) [16](#) [17](#) [18](#) [Next >](#)

From: Kristen Cardwell
Sent: 13 January 2023 12:38
To: Licensing HF: H&F shepherdbushfw
Cc: Collins Elisha: H&F >; Perez-Trillo Cristina: H&F >; Daniel.Evans2
Subject: FW: Shepherds Bush Food And Wine 20 Shepherd's Bush Road London W6 7PJ:- 2023/00012/LAPR

Good Afternoon Licensing,

Please refer to the conditions agreed (highlighted in red below) between the Police and the applicant for the above application.

Please note that the applicant has withdrawn their request to amend condition 6 on the current premises licence and therefore the restriction of 5.5%abv for certain alcohol will remain on the premises licence.

You withdraw your request to amend condition 6 on the premises licence and therefore the sale of beer, lager, stout, ale and cider will remain restricted to 5.5%abv or below.

The sale of alcohol - Off the premises only

Mondays to Sunday - 08:00 to 23:00

Kind regards,

Kris.

Kris Cardwell
Police Constable

From: Cardwell Kris J - AW-CU
Sent: 13 January 2023 12:34
To: Jasmeet Gabha
Cc: Evans Daniel A - AW-CU
Subject: RE: Shepherds Bush Food And Wine 20 Shepherd's Bush Road London W6 7PJ:- 2023/00012/LAPR

Hi Jasmeet,

Many thanks for your email confirming my proposed timings and not amending condition 6. I will inform the Local Authority who will update your application.

Moving forward, if you need anything further then please contact me,

All the best,

Kris.

Kris Cardwell

Police Constable

From: Jasmeet Gabha

Sent: 13 January 2023 11:47

To: Cardwell Kris J - AW-CU

Cc: Evans Daniel A - AW-CU

Subject: Re: Shepherds Bush Food And Wine 20 Shepherd's Bush Road London W6 7PJ:- 2023/00012/LAPR

Dear Kris,

It was nice meeting you too. Yes as discussed I am happy to withdraw condition 6 and a big thank you for allowing us to change the timings. Thanks for your time much appreciated.

Kind Regards
Jasmeet

On Fri, 13 Jan 2023 at 11:06, <Kristen Cardwell wrote:

Good Morning Jasmeet,

It was good to meet you yesterday and discuss your application. I explained the concerns of the Police in relation to increasing the % abv for beers, lagers, ciders and stouts and the reason that this condition has been placed on a significant number of premises licences across Hammersmith and Fulham.

I also explained my concerns in relation to your premises being able to sell alcohol past 23:00 and the fact that by allowing this, I am of the opinion that crime and disorder will increase as a result of these later hours.

The Police do want to work with local businesses and therefore, as discussed, I would not object to the following:-

You withdraw your request to amend condition 6 on the premises licence and therefore the sale of beer, lager, stout, ale and cider will remain restricted to 5.5%abv or below.

The sale of alcohol - Off the premises only

Mondays to Sunday - 08:00 to 23:00

I look forward to hearing from you,

Kind regards,

Kris,

Kris Cardwell

Police Constable

From: Jasmeet Gabha

Sent: 11 January 2023 01:27

To: Cardwell Kris J - AW-CU

Subject: Re: Shepherds Bush Food And Wine 20 Shepherd's Bush Road London W6 7PJ:- 2023/00012/LAPR

Dear Kristen,

Thats fine I will see you at 12.00.

Thanks.

On Tue, 10 Jan 2023 at 21:14, <Kristen.Cardwell> wrote:

Hi Jasmeet,

Many thanks for your email. I am working the football on Thursday, however I could meet you at the premises at 12:00 to discuss your application.

Kind regards,

Kris.

Kris Cardwell

Police Constable

From: Jasmeet Gabha

Sent: 10 January 2023 14:11

To: Cardwell Kris J - AW-CU

Subject: Re: Shepherds Bush Food And Wine 20 Shepherd's Bush Road London W6 7PJ:- 2023/00012/LAPR

Dear Kristen,

Thank you for your email. I hope you are keeping well. I did read everything you stated and I expected a better desired result of the application. I am not in tomorrow but I am more than happy to meet at the premises on Thursday if that is ok with you to discuss this further.

Kind Regards

On Tue, 10 Jan 2023 at 11:55, <Kristen.Cardwell> wrote:

Good Morning Mr Gabha,

My name is Kris Cardwell, I am the Police Licensing Officer for Hammersmith and Fulham. I can confirm that the Metropolitan Police are in receipt of the full variation to the premises licence for Shepherds Bush Food And Wine, 20, Shepherd's Bush Road, London, W6 7PJ as detailed below:-

Licensable activities to vary- The sale of alcohol - Off the premises only

Proposed Hours

Mondays to Thursdays - 08:00 to 00:00

Fridays and Saturdays - 08:00 to 01:00

Sundays - 08:00 to 23:00

Current Hours

Mondays to Saturdays - 11:00 to 23:00

Sundays - 11:00 to 22:30

Condition 6 - The premises shall not sell nor offer for sale the following products in excess of 5.5% alcohol by volume: beer; lager; stout; ale and cider. (The licensee wishes to increase the limit for the strength of alcohol which can be sold from 5.5% to 9%)

By way of background, the entire Borough of Hammersmith and Fulham suffers with street drinkers. Sadly, street drinkers are vulnerable addicts that drink the highest %abv possible to fuel their habit. It is well evidenced that their behaviour includes, shouting, swearing, spitting, vomiting and often their behaviour leads to violence. This behaviour is of course particularly unpleasant affects the local community. It is therefore essential that every operate who sells alcohol does so in a responsible manner to address this issue.

A significant amount of work has taken place between the Police, the Local Authority and local residents to deal with street drinkers and specific licensing conditions have been placed on premises licences to restrict the sale of alcohol to street drinkers, hence the 5.5%abv condition. Most other premises have this condition on the licence and the Police would object to any increase such as the one that you have proposed. There are a significant number of products that can be sold which are 5.5%abv or less.

That being said, the Police do want to work with premises and I understand that an increase in the hours of licensable activity would assist your business model. The Police do not want premises such as yours selling alcohol past 23:00 as this creates other problems and will most certainly increase the potential for crime and disorder to take place.

The Police would not object to the following:-

The sale of alcohol - Off the premises only

Mondays to Sunday – 09:00 to 23:00

Please consider my proposal. I am in Hammersmith tomorrow and I am happy to call in to your shop and discuss your application.

I look forward to hearing from you,

Kind regards,

Kris.

Kris Cardwell

Police Constable

London Borough of Hammersmith & Fulham

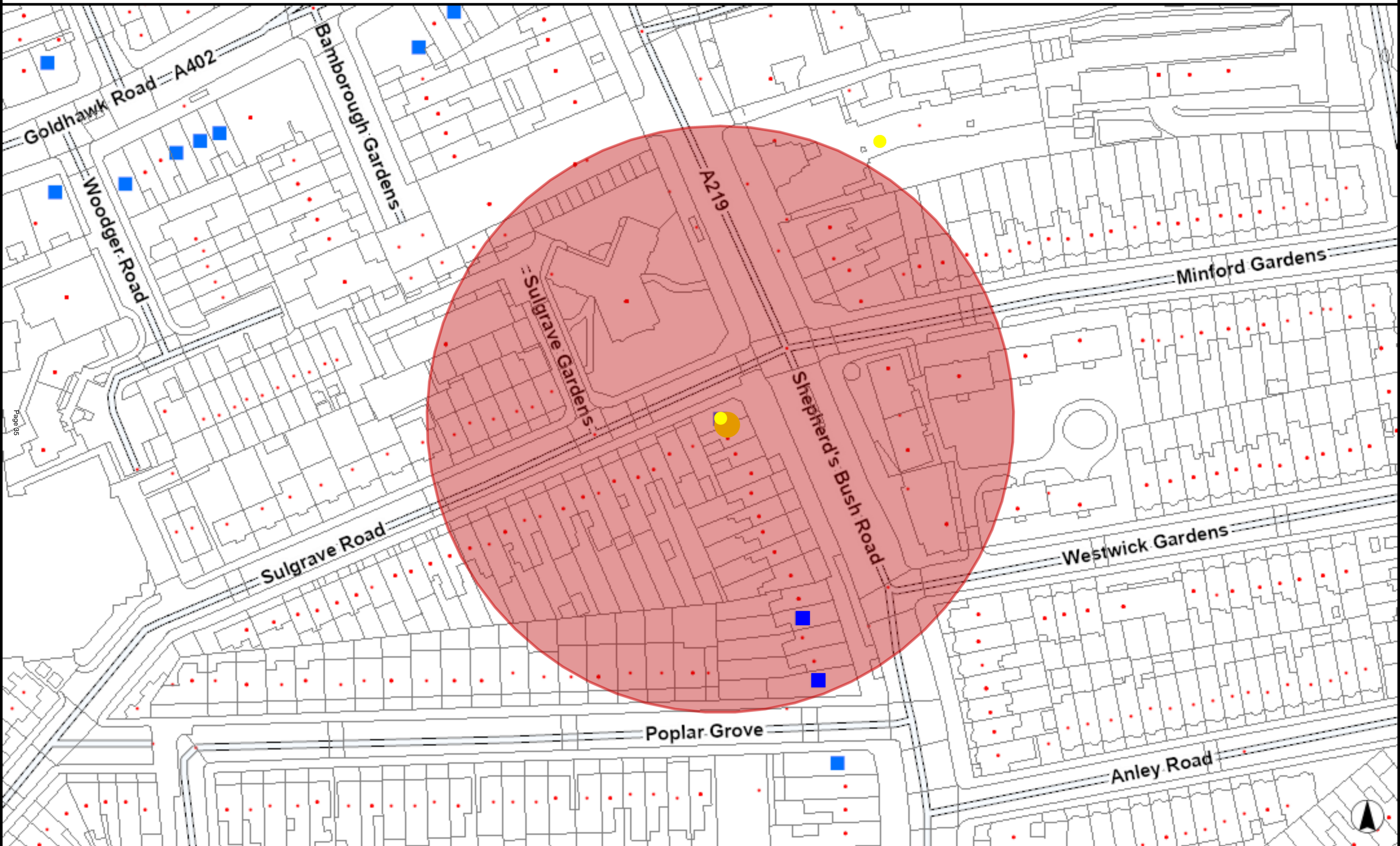

LICENCE NO	TRADING AS	ADDRESS	ACTIVITY	Monday to Sunday	Monday	Tuesday	Wednesday	Thursday	Friday	Saturday	Sunday
2019/00124/LAPR	Pizza Fresco	40 Shepherd's Bush Road London W6 7PJ	Playing of Recorded Music	10:00:00 - 22:00:00							
			Sale of Alcohol On the Premises	12:00:00 - 22:00:00							
2005/03073/LAPRT	Raj Of India Restaurant	46 Shepherd's Bush Road London W6 7PJ	Sale of Alcohol On the Premises		10:00:00 - 00:00:00	10:00:00 - 00:00:00	10:00:00 - 00:00:00	10:00:00 - 00:00:00	10:00:00 - 00:00:00	10:00:00 - 00:00:00	12:00:00 - 23:30:00

Dear Sir/Madam,

Licensing Application comments have been made. A summary of the comments is provided below.

Comments were submitted at 06/01/2023 7:06 AM from

Application Summary

Address: 20 Shepherd's Bush Road London W6 7PJ

Proposal: Licensing Act - Premises Licence

Case Officer: Ms Elisha Collins

[Click for further information](#)

Customer Details

Name:

Email:

Address:

Comments Details

Commenter Type: Neighbour

Stance: Customer objects to the Licensing Application

Reasons for
comment:

Comments: 06/01/2023 7:06 AM There is already a significant ASB problem due to street drinking, begging and associated hostels around the Shepherds Bush Road area. LBHF have in the past restricted alcohol licence in the area to minimise the increased community problems and ASB caused by street drinking.

No additional late night licences or applications to sell stronger alcohol should be granted.

Comments summary

Dear Sir/Madam,

Licensing Application comments have been made. A summary of the comments is provided below.

Comments were submitted at 06/01/2023 7:19 AM from

Application Summary

Address: 20 Shepherd's Bush Road London W6 7PJ

Proposal: Licensing Act - Premises Licence

Case Officer: Ms Elisha Collins

[Click for further information](#)

Customer Details

Name:

Email:

Address:

Comments Details

Commenter Type: Residents Group

Stance: Customer objects to the Licensing Application

Reasons for comment:

Comments: 06/01/2023 7:19 AM Concerned with the rise in ABS in the area as it is, extension of licence could enough more unseemly behaviours, especially with Spring and Summer head out way. The green then becomes one big beer Keller!

Kind regards

Comments summary

Dear Sir/Madam,

Licensing Application comments have been made. A summary of the comments is provided below.

Comments were submitted at 06/01/2023 8:53 AM from

Application Summary

Address: 20 Shepherd's Bush Road London W6 7PJ

Proposal: Licensing Act - Premises Licence

Case Officer: Ms Elisha Collins

[Click for further information](#)

Customer Details

Name:

Email:

Address:

Comments Details

Commenter Type: Residents Group

Stance: Customer objects to the Licensing Application

Reasons for comment:

Comments: 06/01/2023 8:53 AM We already have a huge and dangerous problem with alcoholics in this small residential area.

The streets are not safe because of this

Extending licenses will only increase the problem and the workload on the police

Kind regards

Comments summary

Dear Sir/Madam,

Licensing Application comments have been made. A summary of the comments is provided

below. Comments were submitted at 06/01/2023 9:01 AM from

Application Summary

Address: 20 Shepherd's Bush Road London W6 7PJ

Proposal: Licensing Act - Premises Licence

Case Officer: Ms Elisha Collins

[Click for further information](#)

Customer Details

Name:

Email:

Address:

Comments Details

Commenter
Type: Neighbour

Stance: Customer objects to the Licensing Application

Reasons for
comment:

Comments: 06/01/2023 9:01 AM I object!! This is within the Partial Closure order area of SBG and Caxton Village, in place due to problems relating to the alcoholics present and marauding out streets. The existing hours 11am-11pm do NOT need extending. Residents are impacted by the ASB of the alcoholics. This must not be allowed. Think about the children.

Kind regards

Comments summary

Dear Sir/Madam,

Licensing Application comments have been made. A summary of the comments is provided below.

Comments were submitted at 06/01/2023 10:29 AM from

Application Summary

Address: 20 Shepherd's Bush Road London W6 7PJ

Proposal: Licensing Act - Premises Licence

Case Officer: Ms Elisha Collins

[Click for further information](#)

Customer Details

Name:

Email:

Address:

Comments Details

Commenter Type: Neighbour

Stance: Customer objects to the Licensing Application

Reasons for comment:

Comments: 06/01/2023 10:29 AM Strictly object! we don't need more drunk people on the streets. It is already very dangerous to walk around Shepherd's Bush green after dark

Kind regards

Comments summary

Dear Sir/Madam,

Licensing Application comments have been made. A summary of the comments is provided below.

Comments were submitted at 06/01/2023 10:36 AM from

Application Summary

Address: 20 Shepherd's Bush Road London W6 7PJ

Proposal: Licensing Act - Premises Licence

Case Officer: Ms Elisha Collins

[Click for further information](#)

Customer Details

Name:

Email:

Address:

Comments Details

Commenter Type: Neighbour

Stance: Customer objects to the Licensing Application

Reasons for comment:

Comments: 06/01/2023 10:36 AM Alcohol consumption is one of the major contributors to anti-social behaviour in the residential area adjacent to Shepherds Bush Green. This is especially the case in warmer weather outside normal licensing hours, and selling alcohol should therefore be limited as icy as possible

Kind regards

Dear Sir/Madam,

Licensing Application comments have been made. A summary of the comments is provided below. Comments were submitted at 06/01/2023 12:09 PM from

Application Summary

Address: 20 Shepherd's Bush Road London W6 7PJ

Proposal: Licensing Act - Premises Licence

Case Officer: Ms Elisha Collins

[Click for further information](#)

Customer Details

Name:

Email:

Address:

Comments Details

Commenter Type: Amenity Group

Stance: Customer objects to the Licensing Application

Reasons for comment:

Comments: 06/01/2023 12:09 PM The proliferation of such licence extension should be stopped by the Council. The increase of hours and strength of alcohol can only attract late night revellers and the noise and anti-social behaviour that will accompany it. It may not occur directly outside the premises but be taken back to late night parties where neighbours will be disturbed. It can also cause ASB around the premises where street drinkers will want to hang out and drink extra strong cheap lager and cider. Although this premise is not near our homes, the granting of such licences can be quoted by others so that they too can extend their licences and cause the ASB that always accompanies these extensions. Please oppose this. 11am to 11pm should be sufficient hours fo supply alcohol to those who want to responsibly consume it.

Dear Sir/Madam,

Licensing Application comments have been made. A summary of the comments is provided below.

Comments were submitted at 06/01/2023 1:44 PM from

Application Summary

Address: 20 Shepherd's Bush Road London W6 7PJ

Proposal: Licensing Act - Premises Licence

Case Officer: Ms Elisha Collins

[Click for further information](#)

Customer Details

Name:

Email:

Address:

Comments Details

Commenter Type: Residents Group

Stance: Customer objects to the Licensing Application

Reasons for comment:

Comments: 06/01/2023 1:44 PM The Caxton Village Tenants and Residents Association (TRA) strongly objects to this application.

Ours is an area where residents have long had to deal with an unreasonable amount of antisocial behaviour, drug dealing and using, and violent crime. You may be aware that Caxton Village and Shepherd's Bush Green is currently under a partial closure order agreement - enforced by Sergeant Thomas Cook from the SNT) because of this anti social behaviour (urination, defecation, drug dealing, and using etc), and other crime.

Caxton Village in particular does not welcome anything that will exacerbate the existing problems in these five streets.

The SNT (police) will tell you that there is a direct correlation between late licensing and antisocial behaviour and crime (including drug use and drug violent. We request that the council liaise with the SNT re. late license applications and that you exercise a blanket rejection of any applications for late licensing along Uxbridge Road, and around Shepherd's Bush Green.

It should not have to fall to local residents - many of whom will not be aware of these planning applications - to object.

The partial closure order has temporarily reduced ASB and crime in our streets significantly. We need to maintain this reduction. Late licenses will do the opposite.

Comments summary

Dear Sir/Madam,

Licensing Application comments have been made. A summary of the comments is provided below.

Comments were submitted at 06/01/2023 1:45 PM from

Application Summary

Address: 20 Shepherd's Bush Road London W6 7PJ

Proposal: Licensing Act - Premises Licence

Case Officer: Ms Elisha Collins

[Click for further information](#)

Customer Details

Name:

Email:

Address:

Comments Details

Commenter Type: Residents Group

Stance: Customer objects to the Licensing Application

Reasons for comment:

Comments: 06/01/2023 1:45 PM Hi, that it is within the Partial Closure order area of SBG and Caxton Village, in place due to problems relating to the alcoholics present and marauding out streets, we already have a huge issue with drug abuse and alcohol abuse in this area. I have sleepless nights because of it, we do not need anymore of this on our streets. 11 pm closure is already lengthy enough.

Kind regards

Comments summary

Dear Sir/Madam,

Licensing Application comments have been made. A summary of the comments is provided below.

Comments were submitted at 06/01/2023 1:59 PM from .

Application Summary

Address: 20 Shepherd's Bush Road London W6 7PJ

Proposal: Licensing Act - Premises Licence

Case Officer: Ms Elisha Collins

[Click for further information](#)

Customer Details

Name:

Email:

Address:

Comments Details

Commenter Type: Neighbour

Stance: Customer objects to the Licensing Application

Reasons for comment:

Comments: 06/01/2023 1:59 PM I want to submit these objections:
- there is a Partial Closure order area of SBG and Caxton Village, in place due to problems relating to the alcoholics present and marauding out streets
- their existing hours 11am-11pm do NOT need extending
- residents are impacted by the ASB of the alcoholics

Kind regards

Dear Sir/Madam,

Licensing Application comments have been made. A summary of the comments is provided below.

Comments were submitted at 07/01/2023 9:22 AM from

Application Summary

Address: 20 Shepherd's Bush Road London W6 7PJ

Proposal: Licensing Act - Premises Licence

Case Officer: Ms Elisha Collins

[Click for further information](#)

Customer Details

Name:

Email:

Address:

Comments Details

Commenter Type: Neighbour

Stance: Customer objects to the Licensing Application

Reasons for comment:

Comments: 07/01/2023 9:22 AM I and The Caxton Village Tenants and Residents Association (TRA) strongly objects to this application.

Ours is an area where residents have long had to deal with an unreasonable amount of antisocial behaviour, drug dealing and using, and violent crime. You may be aware that Caxton Village and Shepherd's Bush Green is currently under a partial closure order agreement - enforced by Sergeant Thomas Cook from the SNT) because of this anti social behaviour (urination, defecation, drug dealing, and using etc), and other crime.

Caxton Village in particular does not welcome anything that will exacerbate the existing problems in these five streets.

The SNT (police) will tell you that there is a direct correlation between late licensing and antisocial behaviour and crime (including drug use and drug violent. We request that the council liaise with the SNT re. late license applications and that you exercise a blanket rejection of any applications for late licensing along Uxbridge Road, and around Shepherd's Bush Green.

It should not have to fall to local residents - many of whom will not be aware of these planning applications - to object.

The partial closure order has temporarily reduced ASB and crime in our streets significantly. We need to maintain this reduction. Late licenses will do the opposite.

Comments summary

Dear Sir/Madam,

Licensing Application comments have been made. A summary of the comments is provided below.

Comments were submitted at 07/01/2023 11:12 AM from

Application Summary

Address: 20 Shepherd's Bush Road London W6 7PJ

Proposal: Licensing Act - Premises Licence

Case Officer: Ms Elisha Collins

[Click for further information](#)

Customer Details

Name:

Email:

Address:

Comments Details

Commenter Type: Neighbour

Stance: Customer objects to the Licensing Application

Reasons for comment:

Comments: 07/01/2023 11:12 AM Speaking as a local resident , there have been longstanding issues of alcoholism and anti social behaviour on Shepherd's Bush Green, which often spills into the surrounding streets. I've lost count of the number of times I've witnessed public urination and defecation in the area.
As such, I would strongly argue that it is wholly inappropriate to extend licencing when it is clear there are issues with alcohol in the neighbourhood.

Kind regards

Comments summary

Dear Sir/Madam,

Licensing Application comments have been made. A summary of the comments is provided below.

Comments were submitted at 07/01/2023 3:19 PM from

Application Summary

Address: 20 Shepherd's Bush Road London W6 7PJ

Proposal: Licensing Act - Premises Licence

Case Officer: Ms Elisha Collins

[Click for further information](#)

Customer Details

Name:

Email:

Address:

Comments Details

Commenter Type: Neighbour

Stance: Customer objects to the Licensing Application

Reasons for comment:

Comments: 07/01/2023 3:19 PM I have objected for the following reasons: 1) Increases in alcohol and drug related crime & ASB on SBG and Caxton Village since the summer of 2022 have resulted in current partial closure order being required. The last thing we need is stronger alcohol being sold and it being licensed to buy later. 2) We have a lot of hostels catering for those without homes and those with alcohol and substance use disorders. It would therefore be hugely irresponsible of LBHF to grant this kind of license so close to these hostels.

Kind regards

Dear Sir/Madam,

Licensing Application comments have been made. A summary of the comments is provided

below. Comments were submitted at 07/01/2023 8:40 PM from

Application Summary

Address: 20 Shepherd's Bush Road London W6 7PJ

Proposal: Licensing Act - Premises Licence

Case Officer: Ms Elisha Collins

[Click for further information](#)

Customer Details

Name:

Email:

Address:

Comments Details

Commenter Type: Neighbour

Stance: Customer objects to the Licensing Application

Reasons for comment:

Comments: 07/01/2023 8:40 PM I object to this application.

The location of the store is within the partial closure order zone, in place as a result of increased drug/alcohol use, antisocial behaviour, urination and defecation on the streets, drug dealing, assaults and other related crimes over recent months.

Further, our local police team have said themselves that there is a direct correlation between late licensing and the types of crimes listed above.

There are many heavy alcohol users that congregate on Shepherd's Bush Green. Late licensing would not be good for these people that instead need help, not greater access in late hours.

Extending of licensing hours to sell alcohol, considering all the above is wholly inappropriate and irresponsible.

Increasing the alcohol percentage from 5.5% to 9%, considering all the above is wholly inappropriate and irresponsible.

It is on these bases that I wholly object to this application.

Dear Sir/Madam,

Licensing Application comments have been made. A summary of the comments is provided

below. Comments were submitted at 07/01/2023 8:43 PM from

Application Summary

Address: 20 Shepherd's Bush Road London W6 7PJ

Proposal: Licensing Act - Premises Licence

Case Officer: Ms Elisha Collins

[Click for further information](#)

Customer Details

Name:

Email:

Address:

Comments Details

Commenter
Type: Neighbour

Stance: Customer objects to the Licensing Application

Reasons for
comment:

Comments: 07/01/2023 8:43 PM I object to this application.

The location of the store is within the partial closure order zone, in place as a result of increased drug/alcohol use, antisocial behaviour, urination and defecation on the streets, drug dealing, assaults and other related crimes over recent months.

Further, our local police team have said themselves that there is a direct correlation between late licensing and the types of crimes listed above.

There are many heavy alcohol users that congregate on Shepherd's Bush Green. Late licensing would not be good for these people that instead need help, not greater access in late hours.

Extending of licensing hours to sell alcohol, considering all the above is wholly inappropriate and irresponsible.

Increasing the alcohol percentage from 5.5% to 9%, considering all the above is wholly inappropriate and irresponsible.

It is on these bases that I wholly object to this application.
